

## GW-SMF Multi Grip Steel Rivet

Dome head · Steel body · Steel stem · Multi-grip  
3.2 mm (1/8") - 6.4 mm (1/4")

### Features

- Multi-grip capability accommodates wide variations in material thickness
- Good hole fill provides strong, vibration resistant joints
- Compensates for irregular, oversized, slotted or misaligned holes
- Can stop sheet movement in non-standard holes
- Retained stem avoids damage, electrical problems or rattling caused by loose stems
- Provides a large blind side bearing area against the rear sheet
- Spreads the tail bearing load/clamp load on the rear sheet making it ideal for use in thin sheet materials

### Material

- Body: Carbon steel, zinc coated
- Stem: Carbon steel, zinc coated

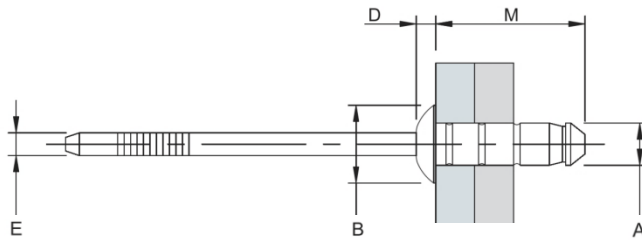

Before Placement

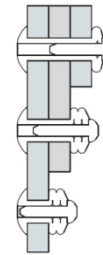

After Placement

Part No.	Size ø	Grip Range		Hole Size		M	øA	øB	D	øE	Shear (typical) kN	Tension (typical) kN
		min.	max.	min.	max.							
GW-SMF-0414	3.2 (1/8")	1.0	7.0	3.3	3.4	14.2	3.3	7.6	1.1	2.2	1.0	1.4
GW-SMF-0516	4.0 (5/32")	2.0	8.0	4.1	4.3	15.1	4.1	8.4	1.5	2.7	1.5	2.0
GW-SMF-0611		1.5	5.1			12.2						
GW-SMF-0614	4.8 (3/16")	1.5	6.3	4.9	5.1	13.7	4.9	10.1	1.6	3.3	2.7	2.9
GW-SMF-0618		1.5	9.5			17.0						
GW-SMF-0818	6.4 (1/4")	1.5	7.6	6.5	6.6	19.0	6.48	13.2	2.8	4.2	3.1	3.6



### Can't find what you are looking for?

We can provide customized finishing and colouring.  
Contact your nearest [Gripwell](#) team for assistance!